

Sands

T47N R25W

Township

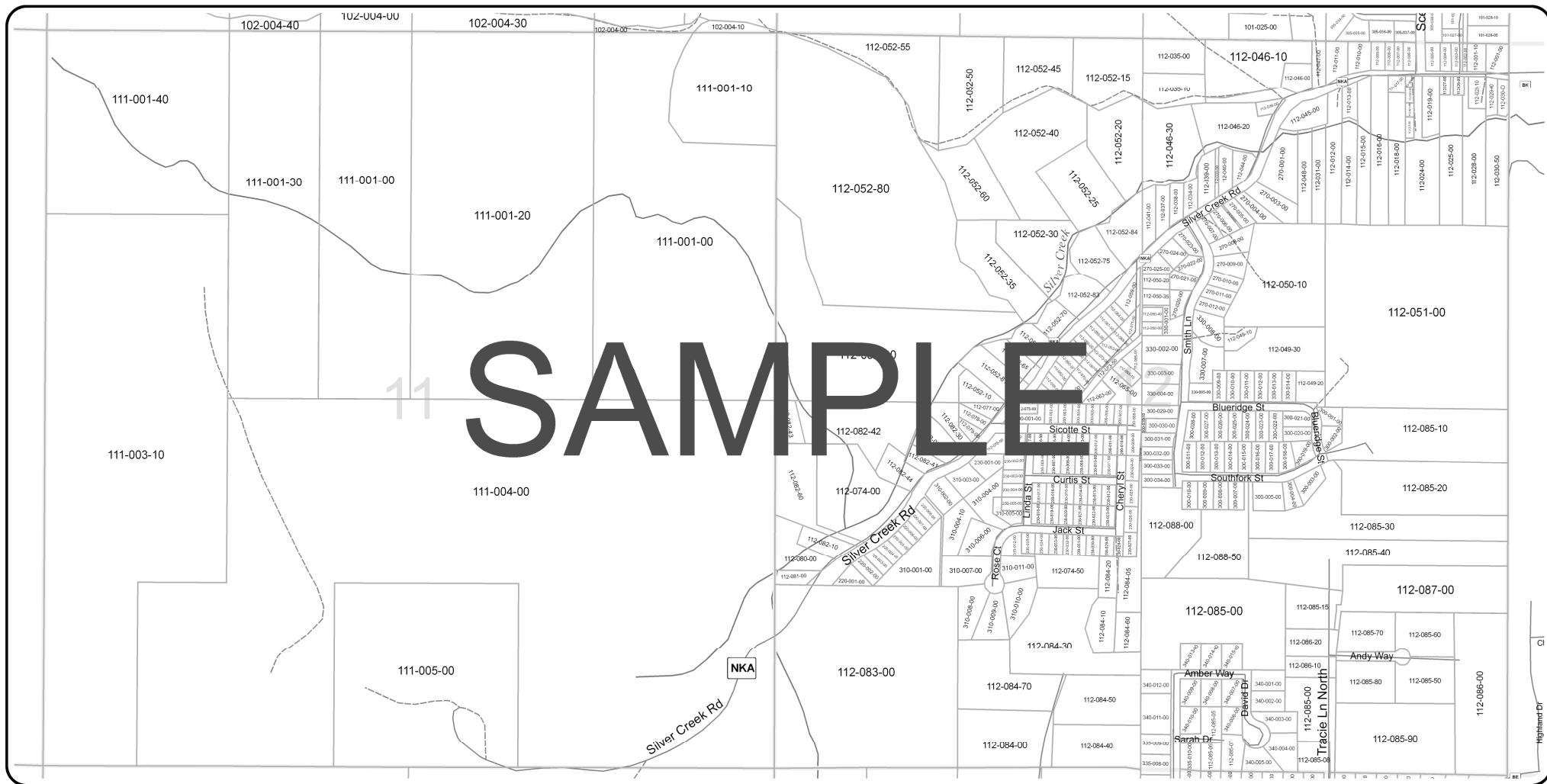

© 2009 Marquette County Equalization Department  
 All Sands Township Tax ID Numbers have a prefix of "52-14-"  
 Not intended for legal use  
 Not responsible for any errors or omissions

**Legend**

Parcels	Highways	Active RR
Section Lines	Primary Roads	Abandoned RR
Government Lots	Secondary Roads	Rivers
	Unclassed Roads	Lakes

